



11 Simon De Montfort Drive, Evesham, WR11 4NR

Offers over £500,000

 4

 1

 2

 D



CHRISTIA
LEWIS

11 Simon De Montfort Drive

Evesham, WR11 4NR

- A substantial dormer style bungalow situated on a corner plot
- Four double bedrooms
- Sunny facing rear garden
- Utility room
- Spacious living
- Sought after location
- Lovingly owner and cherished by the same owner for many years
- Ample parking with large tandem garage
- Flexible living
- Must be viewed

This detached home, located on the highly sought-after Simon De Montfort Drive, offers remarkable flexibility.

Lovingly owned and cherished by the current owner for many years, this well-maintained property has immense potential. Its adaptable layout is ideal for those considering single-storey living in the near future.

Situated on a corner plot, the house includes a porch, hall, living room, two reception rooms that can also serve as downstairs bedrooms, a kitchen/diner, tandem-length garage, utility room, and a WC. The first floor features two additional double bedrooms and a family bathroom. Additional benefits include a large driveway with ample parking, a sunny rear garden, and front and side gardens.



Additional Information

Tenure: We understand that the property is for sale Freehold.

Local Authority: Tewkesbury

Council Tax Band: We understand that the Council Tax Band for the property is Band F

EPC Rating: D

Disclaimer

Whilst we make enquiries with the Seller to ensure the information provided is accurate, Christian Lewis makes no representations or warranties of any kind with respect to the statements contained in the particulars which should not be relied upon as representations of fact. All representations contained in the particulars are based on details supplied by the Seller. Your Conveyancer is legally responsible for ensuring any purchase agreement fully protects your position. Please inform us if you become aware of any information being inaccurate.







Floor Plans

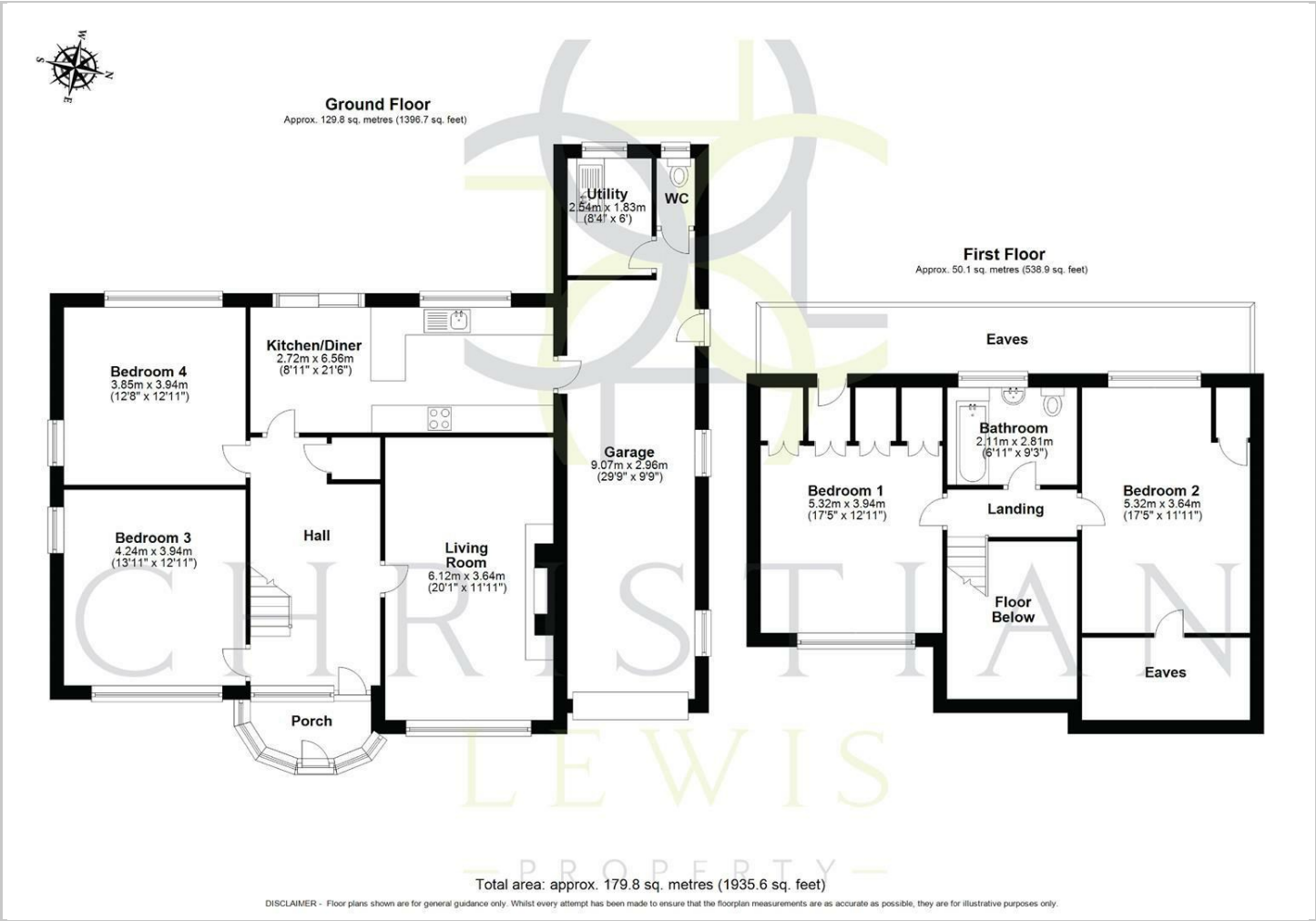

Viewing

Please contact our Evesham Office on 01386 442929 if you wish to arrange a viewing appointment for this property or require further information.

The particulars are set out as a general outline only for the guidance of intended purchasers or lessees, and do not constitute, any part of a contract. Nothing in these particulars shall be deemed to be a statement that the property is in good structural condition or otherwise nor that any of the services, appliances, equipment or facilities are in good working order. Purchasers should satisfy themselves of this prior to purchasing.

Location Map

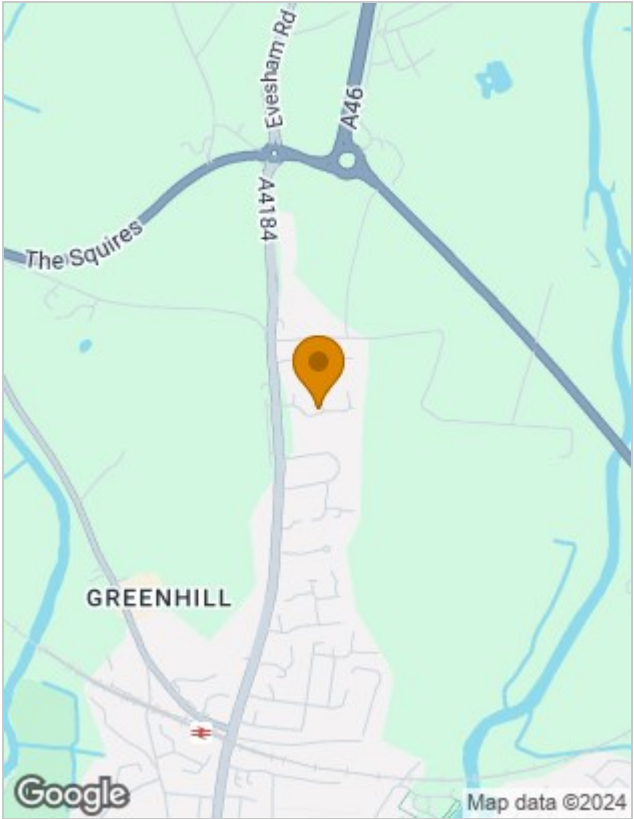

Energy Performance Graph

